

PICNIC SETTING

Designer: Aaron Tuck



SLATS

- Oiled hardwood
- Composite

FRAME

- Hot dip galvanised mild steel

FRAME FINISH

- Powdercoat

INSTALLATION

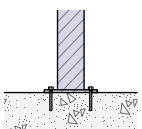

Bolt Down

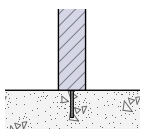

Concealed Fix

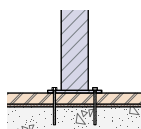

Bolt Through

FIXINGS

- 12mm fixings for 14mm for diameter holes

Alternative finishes available on request

SUSPEND PICNIC SETTING

SPECIFICATIONS

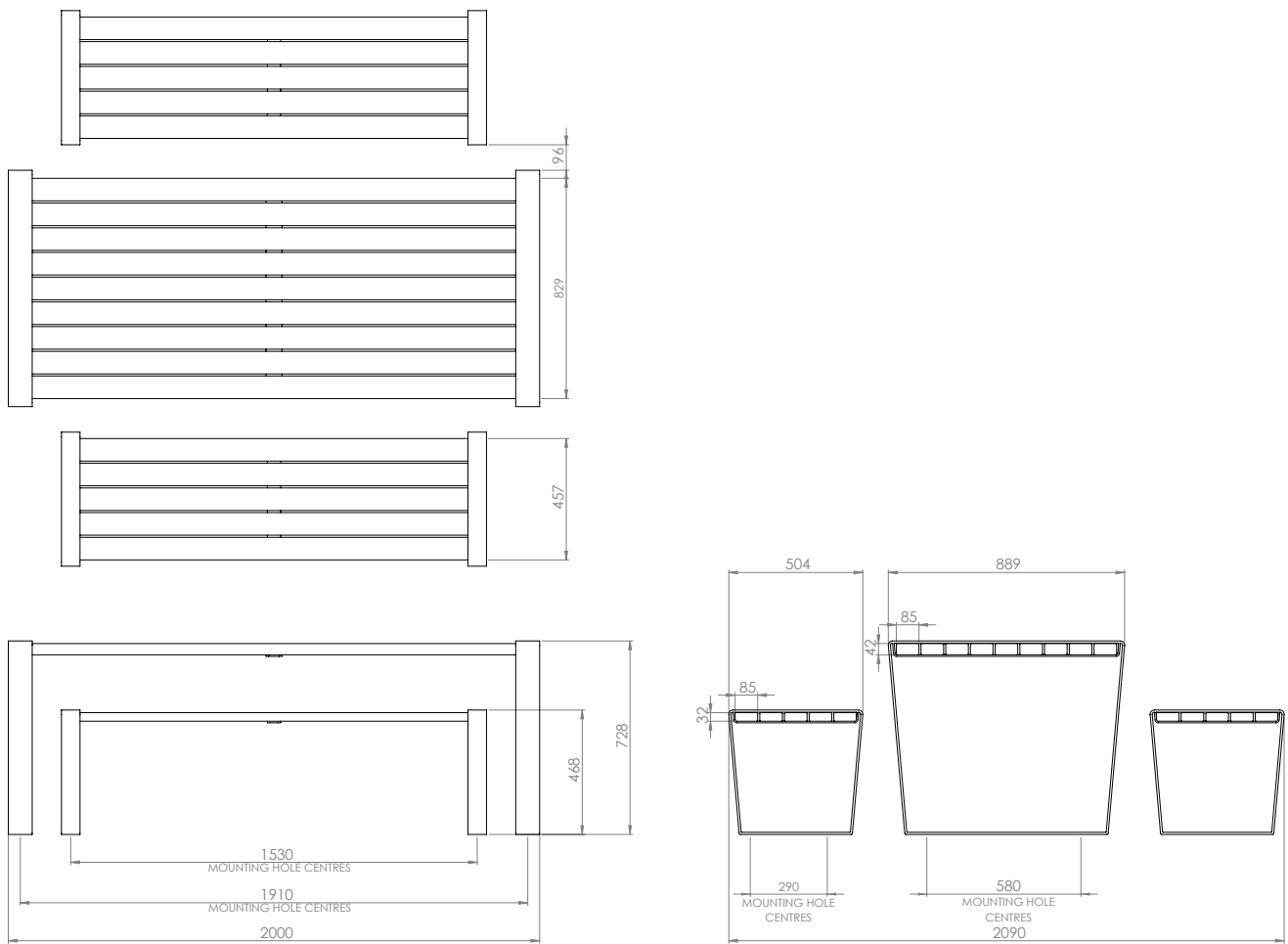

Measurements are in millimetres. Drawings are not to scale.
Dimensions shown are for timber slat option

PRODUCT CODE	FRAME FINISH	SLAT OPTION & SIZE (mm)
SUS006-HDG-PC-T	Powdercoated	85x32/42 Oiled hardwood timber
SUS006-HDG-PC-C	Powdercoated	90x40 Composite